

STAINLESS STEEL COMPATIBLE LASER WELDABLE SUB-D CONNECTOR

REVISIONS			
REV	CHANGE NO.	DATE	RELEASE APPROVAL
-	INIT RLSE	3/16/2010	J. PETRI
A	DCN001303	1/31/2014	J. PETRI
B	DCN001507	3/3/2015	

- TRADITIONAL CONFIGURATION WITH THE FLANGE LOCATED AT THE MIDSECTION OF THE CONNECTOR
- DESIGNED TO LASER WELD INTO AN ELECTRONIC CHASSIS WALL
- CONFORMS TO MIL-DTL-24308, ARRANGEMENT 2 PIN COUNTS 15, 26, 44, 62, 78 AND ARRANGEMENT 1 PIN COUNT 104 CONTACT CONFIGURATIONS.
- INCORPORATES BERYLLIUM-COPPER CONTACTS INDIVIDUALLY SEALED USING CERAMAX® PROPRIETARY CERAMIC TO ESTABLISH A DURABLE HERMETIC SEAL.
- THE INTERNAL PINS CAN BE CONFIGURED TO ACCEPT INSULATED WIRE, AUTOMATIC WIRE BONDS, RIBBON WELDS, OR SOLDER CONNECTIONS.

1. LEAK RATE: LESS THAN OR EQUAL TO 1X10E-9 CC/SEC He AT ONE ATMOSPHERE DIFFERENTIAL PRESSURE.
2. INTERFACE AND MOUNTING HOLES IN ACCORDANCE WITH MIL-DTL-24308/2.
3. MATERIALS:
CONTACT: BERYLLIUM-COPPER ALLOY 172/173 IN ACCORDANCE WITH ASTM B196/197.
INSULATOR: CERAMAX PROPRIETARY CERAMIC.
SHELL: STAINLESS STEEL 304L IN ACCORDANCE WITH SAE AMS-QQ-S-763.
4. FINISH:
CONTACTS: NICKEL PLATE PER QQ-N-290, .000100/.000250 THICK.
GOLD PLATE PER ASTM B488, TYPE III, CODE A, .000050/.000100 THICK.
PLATE ENTIRE EXPOSED PIN, BOTH ENDS.

SHELL: PASSIVATED
5. ORDERING INSTRUCTIONS:
SPECIFY BASE NUMBER FOLLOWED BY DASH NUMBERS INDICATING PIN COUNT AND CONFIGURATION (SEE SHEET 2):

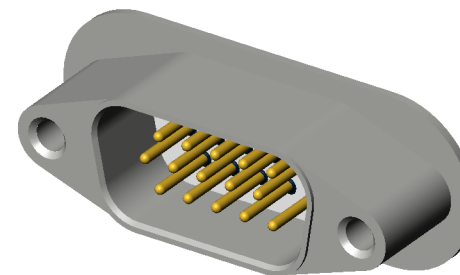
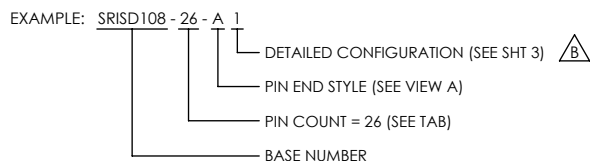

UNLESS OTHERWISE SPECIFIED				(321) 254-4067
DIMENSIONING IAW ASME Y14.5M-1994		DIMENSIONS APPLY AFTER PROCESSES		DIMENSIONS IAW US CUSTOMARY UNITS
.X ± .1, .XX ± .01, .XXX ± .005, ∠ ± .5°		.010 MAX OUTSIDE R, .005 MAX INSIDE R		125 RMS SURFACE FINISH
THIRD ANGLE PROJECTION		TITLE		CONNECTOR, SUB-D, MID FLANGED, SC LBW
		SIZE	DOCUMENT	SRISD108
SCALE		2:1	CAGE CODE	3PJY7
		SHEET	1 OF 3	

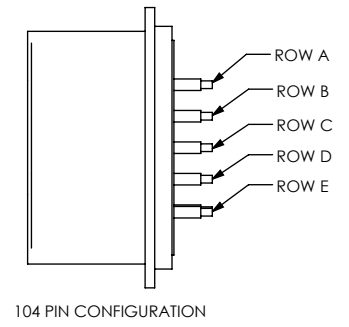
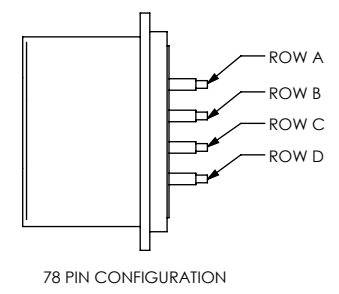
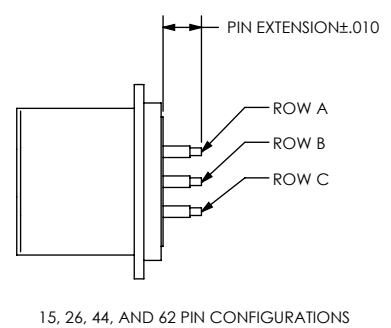
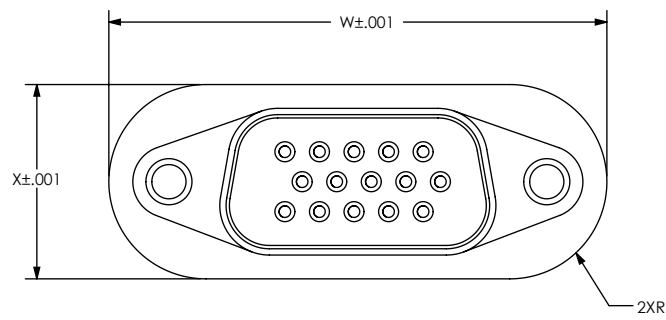

15, 26, 44, AND 62 PIN CONFIGURATIONS

78 PIN CONFIGURATION

104 PIN CONFIGURATION

PIN EXTENSIONS (SEE SH 3)

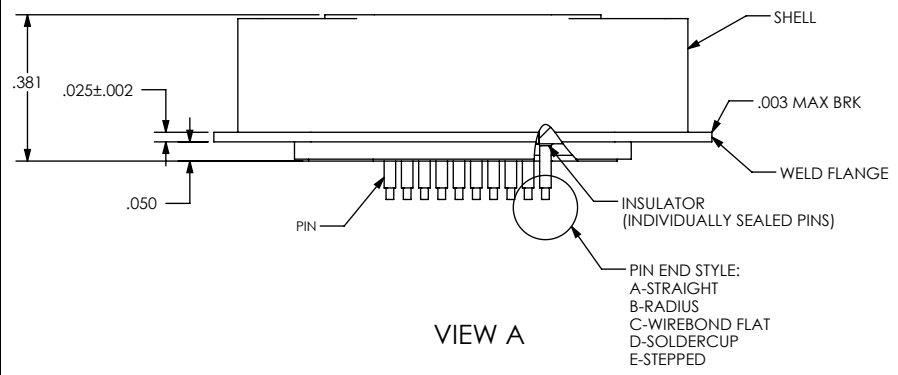

VIEW A

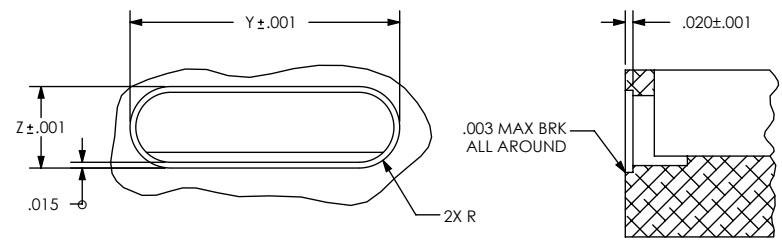

HOLE DETAIL

MIL-DTL-24308 ARRANGEMENT	CONTACT SIZE	PIN COUNT	W	X	Y	Z
1	22D (Ø .030)	104	2.814	.730	2.817	.733
2	22D (Ø .030)	15	1.297	.506	1.300	.509
2	22D (Ø .030)	26	1.625	.506	1.628	.509
2	22D (Ø .030)	44	2.165	.506	2.168	.509
2	22D (Ø .030)	62	2.814	.506	2.817	.509
2	22D (Ø .030)	78	2.720	.618	2.723	.621

UNLESS OTHERWISE SPECIFIED
 DIMENSIONING IAW ASME Y14.5M-1994
 DIMENSIONS APPLY AFTER PROCESSES
 DIMENSIONS IAW US CUSTOMARY UNITS
 .X±.1, .XX±.01, .XXX±.005, ∠ ±.5°
 .010 MAX OUTSIDE R, .005 MAX INSIDE R
 125 RMS SURFACE FINISH



(321) 254-4067
 WWW.SRIHERMETICS.COM

TITLE			
CONNECTOR, SUB-D, MID FLANGED, SC LBW			
SIZE	DOCUMENT	SRISD108	REV
A			B
SCALE	CAGE CODE	3PJY7	SHEET
2:1			2 OF 3

THIRD ANGLE PROJECTION

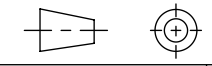

STRAIGHT PIN END STYLE, A

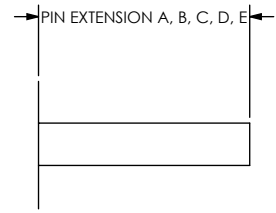

PART NUMBER	A	B	C	D	E
SRISD108 - X - A1	.345	.345	.345	.345	.345
SRISD108 - X - A2	.150	.150	.150	.150	.150

RADIUS PIN END STYLE, B

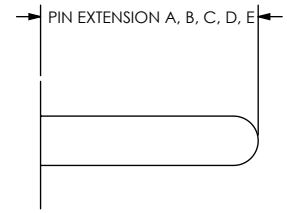

PART NUMBER	A	B	C	D	E
SRISD108 - X - B1	.360	.360	.360	.360	.360
SRISD108 - X - B2	.165	.165	.165	.165	.165

WIREBOND FLAT PIN END STYLE, C

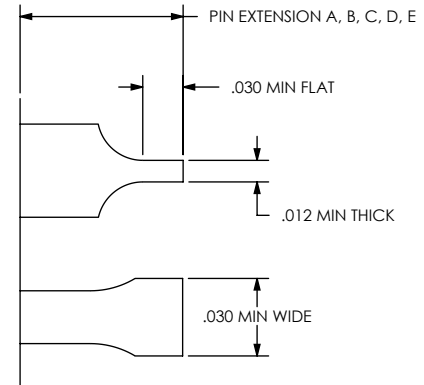

PART NUMBER	A	B	C	D	E
SRISD108 - X - C1	.360	.330	.300	.270	.240

SOLDERCUP PIN END STYLE, D

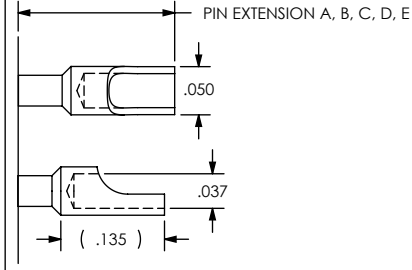

PART NUMBER	A	B	C	D	E
SRISD108 - X - D1	.185	.185	.185	.185	.185

STEPPED PIN END STYLE, E

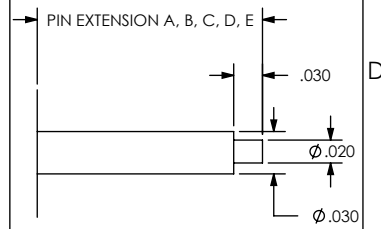

PART NUMBER	A	B	C	D	E
SRISD108 - X - E1	.100	.100	.100	.100	.100
SRISD108 - X - E2	.250	.250	.250	.250	.250

UNLESS OTHERWISE SPECIFIED
 DIMENSIONING IAW ASME Y14.5M-1994
 DIMENSIONS APPLY AFTER PROCESSES
 DIMENSIONS IAW US CUSTOMARY UNITS
 .X ±.1, .XX ±.01, .XXX ±.005, ∠ ±.5°
 .010 MAX OUTSIDE R, .005 MAX INSIDE R
 125 RMS SURFACE FINISH

THIRD ANGLE PROJECTION

SRI HERMETICS (321) 254-4067
 WWW.SRIHERMETICS.COM

TITLE: CONNECTOR, SUB-D, MID FLANGED, SC LBW

SIZE: A DOCUMENT SRISD108 REV: B

SCALE: 2:1 CAGE CODE 3PJY7 SHEET 3 OF 3