

9-37 PIN CONFIGURATIONS

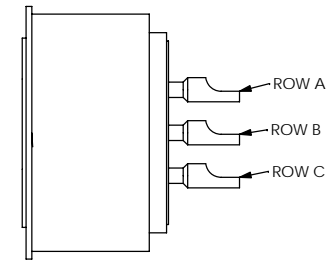

50 PIN CONFIGURATION

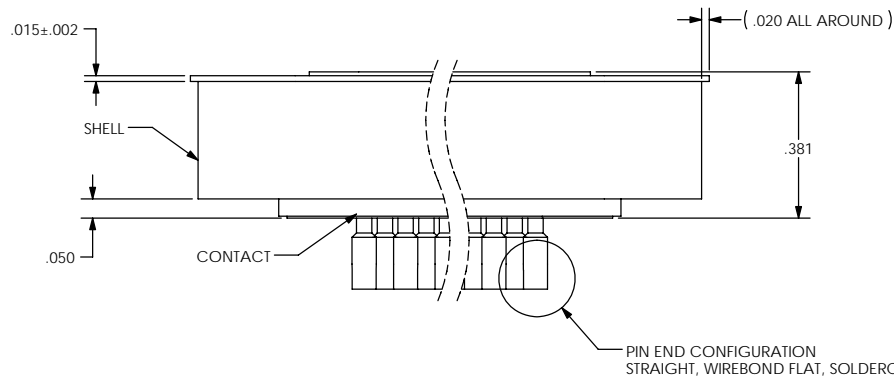

NUMBER OF CONTACTS	W	X	Y	Z
9	1.337	0.546	1.301	0.510
15	1.665	0.546	1.629	0.510
25	2.205	0.546	2.169	0.510
37	2.854	0.546	2.818	0.510
50	2.760	0.658	2.724	0.622

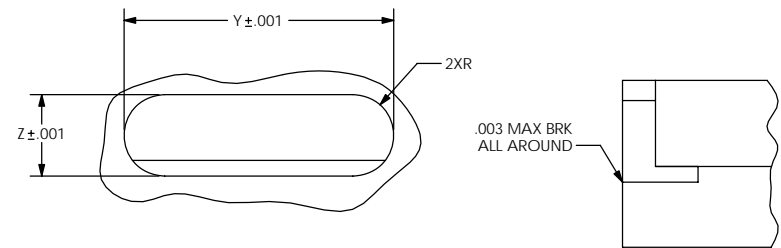

HOLE DETAIL

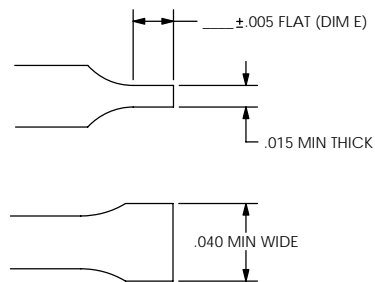

WIREBOND FLAT PIN END CONFIGURATION

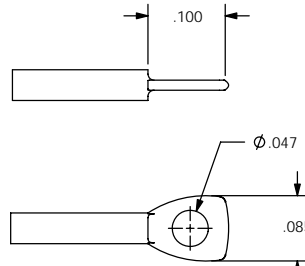

FLATTENED/PIERCED PIN END CONFIGURATION

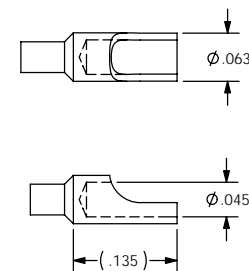

SOLDERCUP PIN END CONFIGURATION

UNLESS OTHERWISE SPECIFIED DIMENSIONING IAW ASME Y14.5M-1994 DIMENSIONS APPLY AFTER PROCESSES DIMENSIONS IAW US CUSTOMARY UNITS .X ± .1, .XX ± .01, .XXX ± .005, ∠ ± 5° .010 MAX OUTSIDE R, .005 MAX INSIDE R 125 RMS SURFACE FINISH		(321) 254-4067 WWW.SRIHERMETICS.COM	
TITLE CONNECTOR, SUB-D, ALUMINUM COMPATIBLE LASER WELDABLE		SRISD104	REV -
SIZE A	DOCUMENT	CAGE CODE	SHEET
SCALE 2:1		3PJY7	2 OF 3

THIRD ANGLE PROJECTION

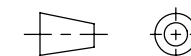

PART NUMBER	PIN EXTENSION			PIN END CONFIGURATION	THREADED INSERT	PIN FINISH	SHELL FINISH	SPECIAL FINISH
	A	B	C					
SRISD104-X-1	0.185	0.185	0.185	SOLDERCUPS	NAS 1130-04-15	NICKEL PLATE PER QQ-N-290, .000100/.000250 THICK GOLD PLATE PER ASTM B488, TYPE 3, CODE A .000050/.000100 THICK	CHEMICAL CONVERSION COAT MIL-C-5541, CLASS 1A	-

UNLESS OTHERWISE SPECIFIED
 DIMENSIONING IAW ASME Y14.5M-1994
 DIMENSIONS APPLY AFTER PROCESSES
 DIMENSIONS IAW US CUSTOMARY UNITS
 .X±.1, .XX±.01, .XXX±.005, ∠ ±.5°
 .010 MAX OUTSIDE R, .005 MAX INSIDE R
 125 RMS SURFACE FINISH



TITLE
 CONNECTOR, SUB-D,
 ALUMINUM COMPATIBLE LASER WELDABLE

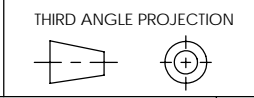

SIZE A	DOCUMENT SRISD104	REV -
SCALE 1:0.333333	CAGE CODE 3PJY7	SHEET 3 OF 3