

# ALUMINUM COMPATIBLE LASER WELDABLE NANO DUAL LOBE SINGLE ROW CONNECTOR

REVISIONS			
REV	DCN	REVISION DATE	RELEASE APPROVAL
-	INIT RLSE	7/16/2010	J. PETRI
A	DCN001400	7/7/2014	J. PETRI
B	DCN001523	4/2/2015	

- CONFIGURATION WITH THE FLANGE LOCATED AT THE TOP OF THE CONNECTOR
- DESIGNED TO LASER WELD INTO A LOW-PROFILE ELECTRONIC CHASSIS WALL
- CONFORMS TO MIL-DTL-32139 AND ARE AVAILABLE IN 9, 15, 21, 25, 31, 37 AND 51 COUNT PIN/SOCKET CONFIGURATIONS.
- INCORPORATES BERYLLIUM-COPPER PIN/SOCKETS INDIVIDUALLY SEALED USING CERAMAX® PROPRIETARY CERAMIC TO ESTABLISH A DURABLE HERMETIC SEAL.
- THE INTERNAL PINS CAN BE CONFIGURED TO ACCEPT INSULATED WIRE, AUTOMATIC WIRE BONDS, RIBBON WELDS, OR SOLDER CONNECTIONS.

1. LEAK RATE: LESS THAN OR EQUAL TO 1X10E-9 CC/SEC He AT ONE ATMOSPHERE DIFFERENTIAL PRESSURE.
2. INTERFACE AND MOUNTING HOLES IN ACCORDANCE WITH MIL-DTL-32139/2.
3. MATERIALS:  
 CONTACT: BERYLLIUM-COPPER ALLOY 172/173 IN ACCORDANCE WITH ASTM B196/197.  
 INSULATOR: CERAMAX PROPRIETARY CERAMIC.  
 WELD FLANGE: ALUMINUM ALLOY 4032 IN ACCORDANCE WITH ASTM B247.
4. FINISH:  
 CONTACTS: NICKEL PLATE PER QQ-N-290, .000100 / .000250 THICK.  
 GOLD PLATE PER ASTM B488-01, TYPE III, CODE A, .000050/.000100 THICK.  
 PLATE ENTIRE EXPOSED PIN, BOTH ENDS.  
 PLATING IN SOCKETS NOT REQUIRED BENEATH BLEED HOLE.  
  
 SHELL: CHEMICAL CONVERSION COAT IN ACCORDANCE WITH MIL-DTL-5541, TYPE II, CLASS 1A.
5. ORDERING INSTRUCTIONS:  
 SPECIFY BASE NUMBER FOLLOWED BY DASH NUMBERS INDICATING PIN COUNT AND CONFIGURATION (SEE SHEETS 2&3):

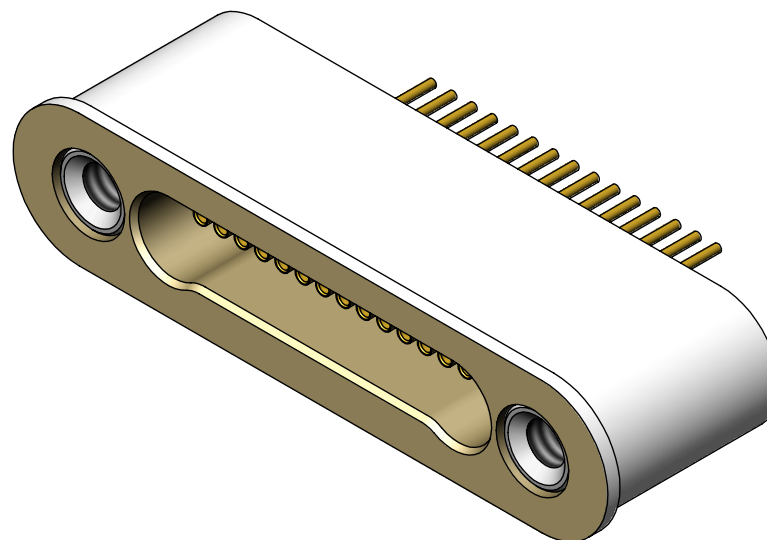
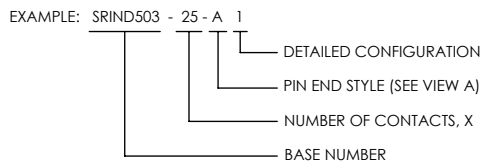

DIMENSIONING IAW ASME Y14.5M-1994  
 DIMENSIONS APPLY AFTER PROCESSES  
 DIMENSIONS IAW US CUSTOMARY UNITS  
 X ± .1, XX ± .01, XXX ± .005, ∠ ± .5°  
 .010 MAX OUTSIDE R, .005 MAX INSIDE R  
 63 RMS SURFACE FINISH  
 THIRD ANGLE PROJECTION

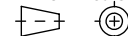

DO NOT SCALE DRAWING

 (321) 254-4067  
[www.srihermetics.com](http://www.srihermetics.com)

TITLE CONNECTOR, 250DL, TOP FLANGE, SINGLE ROW, AC LBW

SIZE DOCUMENT SRIND503 REV B

SCALE 6:1 CAGE CODE 3PJY7 SHEET 1 OF 3

STRAIGHT PIN END STYLE, A

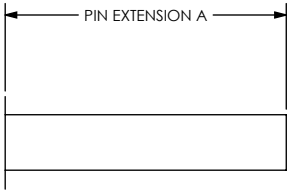

PART NUMBER	A
SRIND503 - X - A 1	.100
SRIND503 - X - A 2	.070

WIREBOND FLAT PIN END STYLE, B

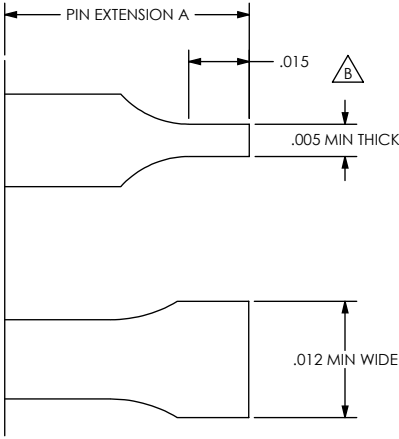

PART NUMBER	A
SRIND503 - X - B 1	.100
SRIND503 - X - B 2	.032
SRIND503 - X - B 3	.050

DIMENSIONING LAW ASME Y14.5M-1994  
 DIMENSIONS APPLY AFTER PROCESSES  
 DIMENSIONS LAW US CUSTOMARY UNITS  
 X ± .1, XX ± .01, XXX ± .005, < 5°  
 .010 MAX OUTSIDE R, .005 MAX INSIDE R  
 63 RMS SURFACE FINISH  
 THIRD ANGLE PROJECTION



**SRI HERMETICS** (321) 254-4067  
 a division of WINCHESTER www.srihermetics.com

TITLE CONNECTOR, 250DL, TOP FLANGE, SINGLE ROW, AC LBW

SIZE DOCUMENT SRIND503 REV B

DO NOT SCALE DRAWING SCALE 6:1 CAGE CODE 3PJY7 SHEET 2 OF 3

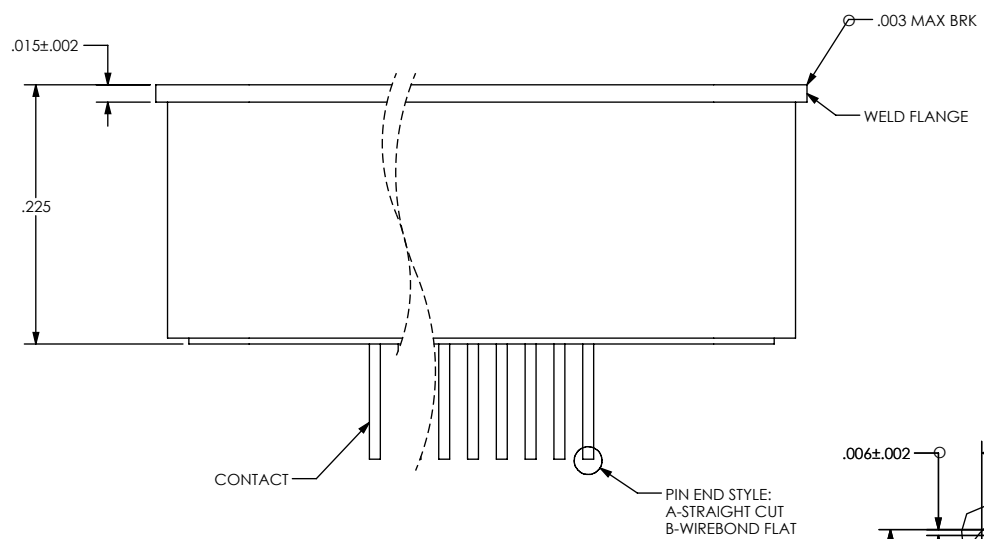
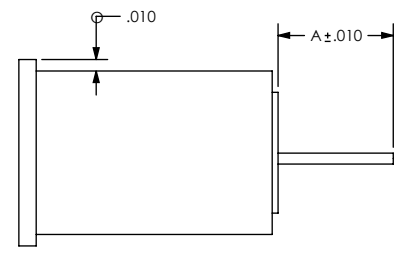
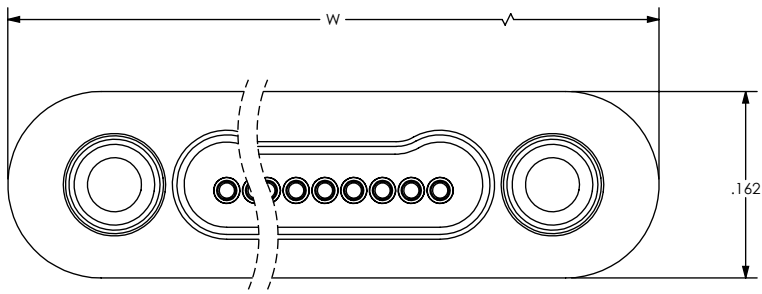

PIN EXTENSIONS (SEE SH 3)

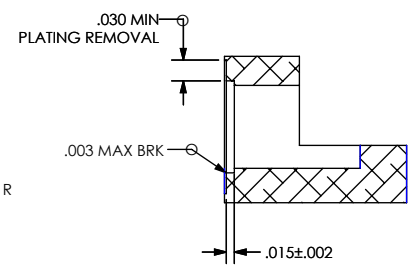
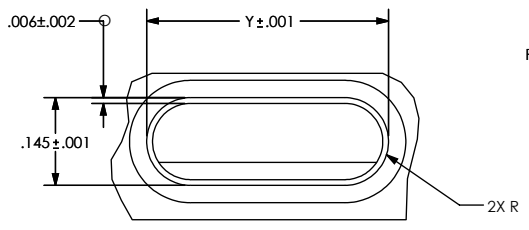

SUGGESTED HOLE DETAIL

NUMBER OF CONTACTS	W	Y
9	0.580	0.563
15	0.730	0.713
21	0.880	0.863
25	0.980	0.963
31	1.130	1.113
37	1.280	1.263
51	1.630	1.613

DIMENSIONING LAW ASME Y14.5M-1994  
 DIMENSIONS APPLY AFTER PROCESSES  
 DIMENSIONS LAW US CUSTOMARY UNITS  
 X ± .1, .XX ± .01, .XXX ± .005, ∠ ± .5°  
 .010 MAX OUTSIDE R, .005 MAX INSIDE R  
 63 RMS SURFACE FINISH  
 THIRD ANGLE PROJECTION

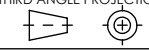

DO NOT SCALE DRAWING



(321) 254-4067  
 www.srihermetics.com

TITLE  
 CONNECTOR, 250DL, TOP FLANGE, SINGLE ROW, AC LBW

SIZE DOCUMENT SRIND503 REV B

SCALE 6:1 CAGE CODE 3PJY7 SHEET 3 OF 3