

# ALUMINUM COMPATIBLE LASER WELDABLE MICRO-D CONNECTOR

REVISIONS			
REV	CHANGE NO.	DATE	APPROVED
-	INIT RLSE	11-04-2004	DC
A	DCN000093	9/22/2005	JP
B	DCN000379	5/13/2009	J. PETRI
C	DCN000837	5/26/2011	J. PETRI
D	DCN001029	5/30/2012	J. PETRI
E	DCN001305	2/19/2014	J. PETRI
F	DCN001810	9/20/2016	

- CONFIGURATION WITH THE FLANGE LOCATED AT THE TOP OF THE CONNECTOR
- DESIGNED TO LASER WELD INTO AN ELECTRONIC CHASSIS WALL
- CONFORMS TO MIL-PRF-83513 AND ARE AVAILABLE IN 9, 15, 21, 25, 31, 37, 51, 69 AND 100 COUNT PIN/SOCKET CONFIGURATIONS.
- INCORPORATES BERYLLIUM-COPPER PIN/SOCKETS INDIVIDUALLY SEALED USING CERAMAX® PROPRIETARY CERAMIC TO ESTABLISH A DURABLE HERMETIC SEAL.
- THE INTERNAL PINS CAN BE CONFIGURED TO ACCEPT INSULATED WIRE, AUTOMATIC WIRE BONDS, RIBBON WELDS, OR SOLDER CONNECTIONS.

1. LEAK RATE: LESS THAN OR EQUAL TO 1X10E-9 CC/SEC He AT ONE ATMOSPHERE DIFFERENTIAL PRESSURE.
2. INTERFACE AND MOUNTING HOLES IN ACCORDANCE WITH MIL-PRF-83513/2.
3. MATERIALS:  
 CONTACT: BERYLLIUM-COPPER ALLOY 172/173 IN ACCORDANCE WITH ASTM B196/197.  
 INSULATOR: CERAMAX PROPRIETARY CERAMIC.  
 WELD FLANGE: ALUMINUM ALLOY 4032 IN ACCORDANCE WITH ASTM B247.  
 THREADED INSERTS: IN ACCORDANCE WITH NAS 1130, NAS 1130-02-15 (9-51), NAS 1130-04-15 (100-PIN)  
 INTERFACIAL SEAL: FLUOROSILICONE RUBBER PER MIL-R-25988, CLASS 1, TYPE II, GRADE 60.
4. FINISH:  
 CONTACTS: NICKEL PLATE PER QQ-N-290, .000100/.000250 THICK.  
 GOLD PLATE PER ASTM B488, TYPE III, CODE A, .000050/.000100 THICK.  
 PLATE ENTIRE EXPOSED PIN, BOTH ENDS.  
 PLATING IN SOCKETS NOT REQUIRED BENEATH BLEED HOLE.  
  
 SHELL FINISH: SEE FINISH TABLE SHEET 2 FOR OPTIONS.
5. ORDERING INSTRUCTIONS:  
 SPECIFY BASE NUMBER FOLLOWED BY DASH NUMBERS INDICATING PIN COUNT AND CONFIGURATION (SEE SHEET 2):

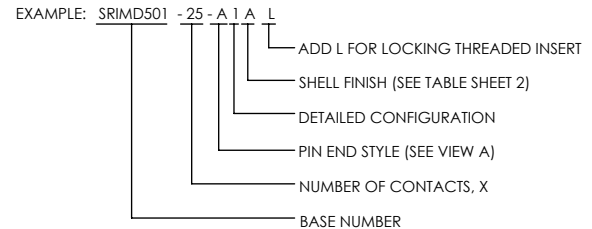
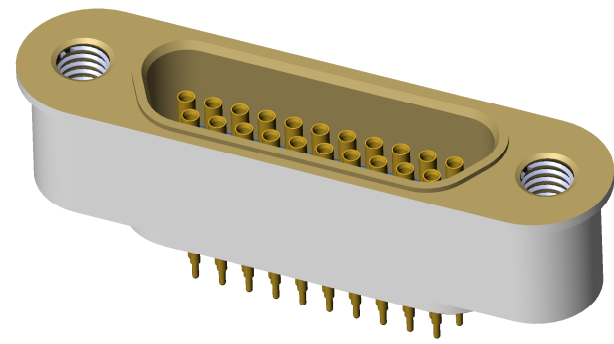

DIMENSIONING IAW ASME Y14.5M-1994  
 DIMENSIONS APPLY AFTER PROCESSES  
 DIMENSIONS IAW US CUSTOMARY UNITS  
 X ± .1, XX ± .01, XXX ± .005, ∠ ± .5°  
 .010 MAX OUTSIDE R, .005 MAX INSIDE R  
 63 RMS SURFACE FINISH  
 THIRD ANGLE PROJECTION

**SRI HERMETICS** (321) 254-4067  
 a division of WINCHESTER www.srihermetics.com

TITLE: CONNECTOR, MICRO-D, TF AC LBW

SCALE: 3:1

DO NOT SCALE DRAWING

DOCUMENT: SRIMD501

CAGE CODE: 3PJY7

SHEET: 1 OF 3

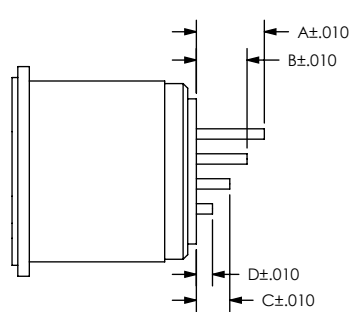
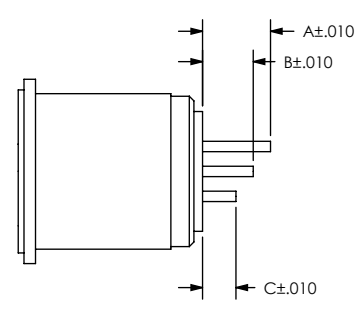
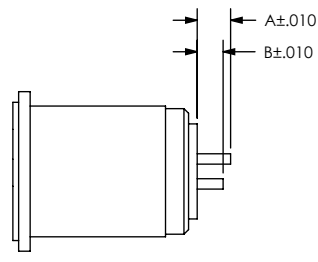
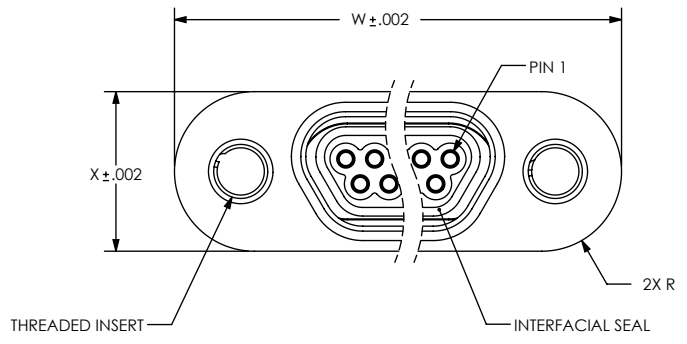

9-37 PIN CONFIGURATIONS

51 PIN CONFIGURATION

100 PIN CONFIGURATION

PIN EXTENSIONS (SEE SH 3)

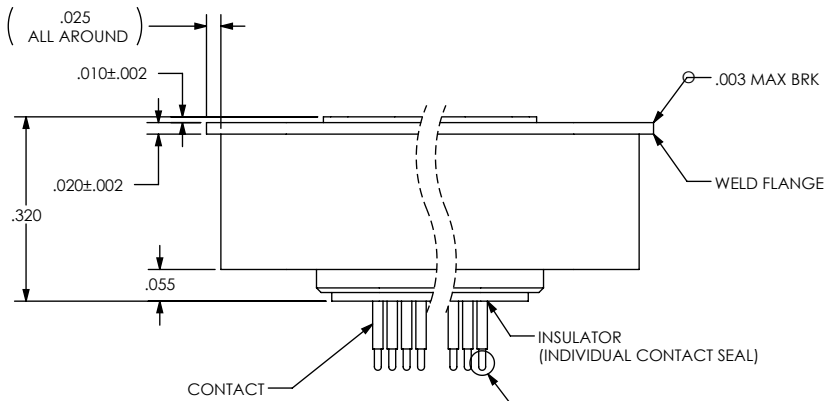

VIEW A

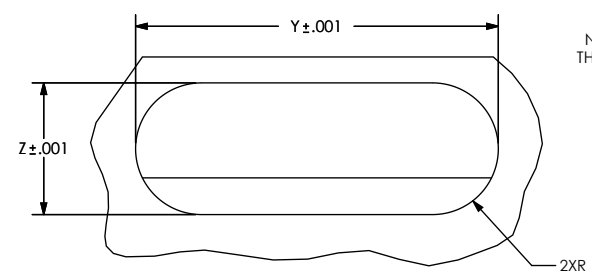

HOLE DETAIL (LAP WELD)

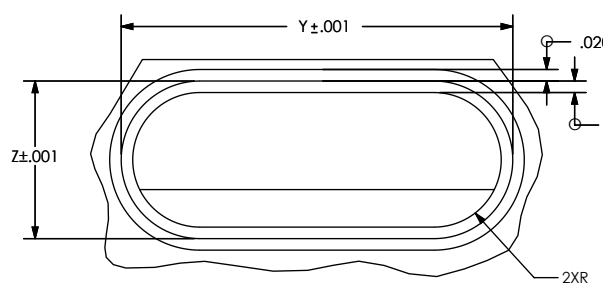
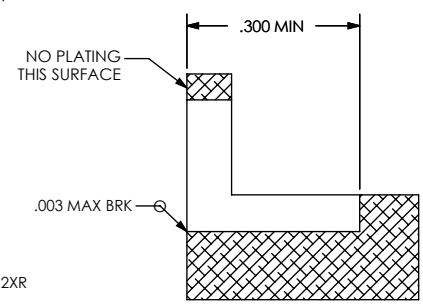

HOLE DETAIL (BUTT WELD)

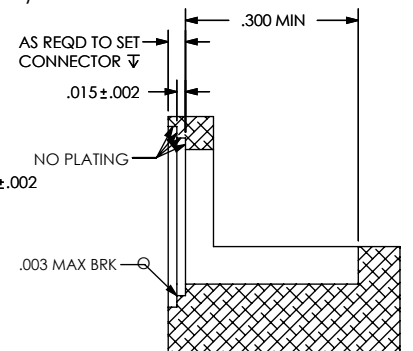

NUMBER OF CONTACTS	W	X	LAP WELD		BUTT WELD	
			Y	Z	Y	Z
9	0.795	0.277	0.748	0.230	0.798	0.280
15	0.945	0.277	0.898	0.230	0.948	0.280
21	1.095	0.277	1.048	0.230	1.098	0.280
25	1.195	0.277	1.148	0.230	1.198	0.280
31	1.345	0.277	1.298	0.230	1.348	0.280
37	1.495	0.277	1.448	0.230	1.498	0.280
51	1.445	0.320	1.398	0.273	1.448	0.323
69	1.745	0.320	1.698	0.273	1.748	0.323
100	2.066	0.364	2.019	0.317	2.069	0.367

FINISH TABLE	
LETTER	SHELL FINISH
(NONE)	CONVERSION COAT PER MIL-DTL-5541, TYPE 1, CL1A
A	CONVERSION COAT PER MIL-DTL-5541, TYPE 1, CL3
B	NO FINISH
C	CONVERSION COAT PER MIL-DTL-5541, TYPE II, CL3

DIMENSIONING IAW ASME Y14.5M-1994  
 DIMENSIONS APPLY AFTER PROCESSES  
 DIMENSIONS IAW US CUSTOMARY UNITS  
 X ±.1, XX ±.01, XXX ±.005, ∠ ±.5°  
 .010 MAX OUTSIDE R, .005 MAX INSIDE R  
 63 RMS SURFACE FINISH  
 THIRD ANGLE PROJECTION

DO NOT SCALE DRAWING

**SRI HERMETICS**  
 a division of WINCHESTER

(321) 254-4067  
 www.srihermetics.com

TITLE: CONNECTOR, MICRO-D, TF AC LBW

SIZE DOCUMENT: SRIMD501 REV F

SCALE: 3:1 CAGE CODE: 3PJY7 SHEET: 2 OF 3

### STRAIGHT PIN END STYLE, A

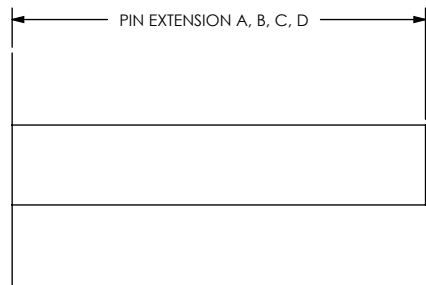

PART NUMBER	A	B	C	D
SRIMD501 - X - A 1	.110	.110	.110	.110
SRIMD501 - X - A 2	.118	.118	.118	.118
SRIMD501 - X - A 3	.045	.075	-	-
SRIMD501 - X - A 4	.095	.095	-	-



### STEPPED PIN END STYLE, B

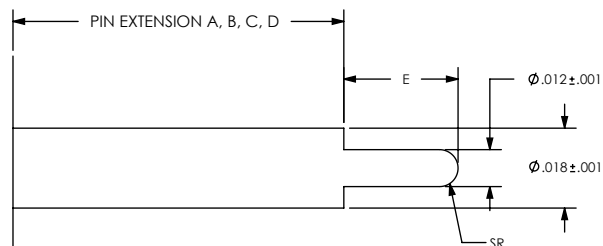

PART NUMBER	A	B	C	D	E
SRIMD501 - X - B 1	.120	.120	.120	.120	.037
SRIMD501 - X - B 2	.083	.083	.083	.083	.037
SRIMD501 - X - B 3	.083	.083	.083	.083	.060

### WIREBOND FLAT PIN END STYLE, C

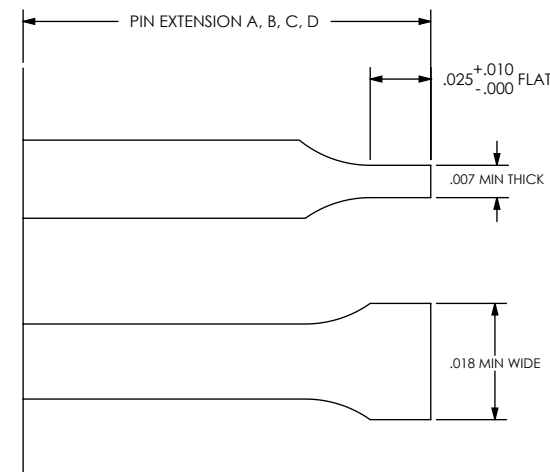

PART NUMBER	A	B	C	D
SRIMD501 - X - C 1	.145	.110	.075	.040
SRIMD501 - X - C 2	.110	.050	-	-
SRIMD501 - X - C 3	.118	.083	-	-
SRIMD501 - X - C 4	.070	.030	-	-
SRIMD501 - X - C 5	.110	.145	-	-
SRIMD501 - X - C 6	.110	.083	-	-

DIMENSIONING IAW ASME Y14.5M-1994  
 DIMENSIONS APPLY AFTER PROCESSES  
 DIMENSIONS IAW US CUSTOMARY UNITS  
 X ± .1, XX ± .01, XXX ± .005, <math>\angle \pm .5^{\circ}</math>  
 .010 MAX OUTSIDE R, .005 MAX INSIDE R  
 63 RMS SURFACE FINISH  
 THIRD ANGLE PROJECTION

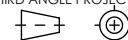

**SRI**  
**HERMETICS**  
 a division of WINCHESTER

(321) 254-4067  
 www.srihermetics.com

TITLE				CONNECTOR, MICRO-D, TF AC LBW	
SIZE	DOCUMENT	SRIMD501	REV	F	
SCALE	3:1	CAGE CODE	3PJY7	SHEET	3 OF 3

DO NOT SCALE DRAWING