

# ALUMINUM COMPATIBLE LASER WELDABLE 50 OHM FEEDTHROUGH, SMP/SMP ADAPTABLE

REVISIONS			
REV	DCN	REVISION DATE	RELEASE APPROVAL
-	INIT RLSE	1/16/2014	<i>[Signature]</i>

- CONFIGURATION FOR INTERFACING TO SMP BULLET ADAPTERS
- DESIGNED TO PRESS FIT AND LASER WELD INTO AN ELECTRONIC CHASSIS
- INDUSTRY STANDARD NICKEL-IRON-COBALT ALLOY CONTACT WITH CORNING 7070 EQUIVALENT GLASS

1. LEAK RATE: LESS THAN OR EQUAL TO 1X10E-9 CC/SEC He AT ONE ATMOSPHERE DIFFERENTIAL PRESSURE.
2. NOMINAL IMPEDANCE: 50 OHMS
3. INTERFACE IN ACCORDANCE WITH MIL-STD-348, SERIES SMP
4. MATERIALS:  
 PIN: NICKEL-IRON-COBALT ALLOY IN ACCORDANCE WITH ASTM F15.  
 DIELECTRIC: CORNING 7070 EQUIVALENT GLASS (LOW LOSS, MATCHED SEAL).  
 SHELL (WELD FLANGE): ALUMINUM ALLOY 4047 IN ACCORDANCE WITH AWS A5.8.
5. FINISH:  
 EXCEPT WELD FLANGE: NICKEL PLATE PER QQ-N-290, CLASS 2, .000100/.000250 THICK  
 GOLD PLATE PER ASTM B488, TYPE III, CODE A, .000050/.000100 THICK.



VIEWS FOR REFERENCE ONLY

6. ORDERING INSTRUCTIONS:  
 SPECIFY BASE NUMBER FOLLOWED BY DASH NUMBERS INDICATING CONNECTOR END DETENT STYLE:

EXAMPLE: SRIFT519 - FD - FD

SMP A DETENT STYLE  
 FD=FULL DETENT  
 LD=FULL DETENT  
 SB=SMOOTH BORE

SMP B DETENT STYLE  
 FD=FULL DETENT  
 LD=LIMITED DETENT  
 SB=SMOOTH BORE

BASE NUMBER

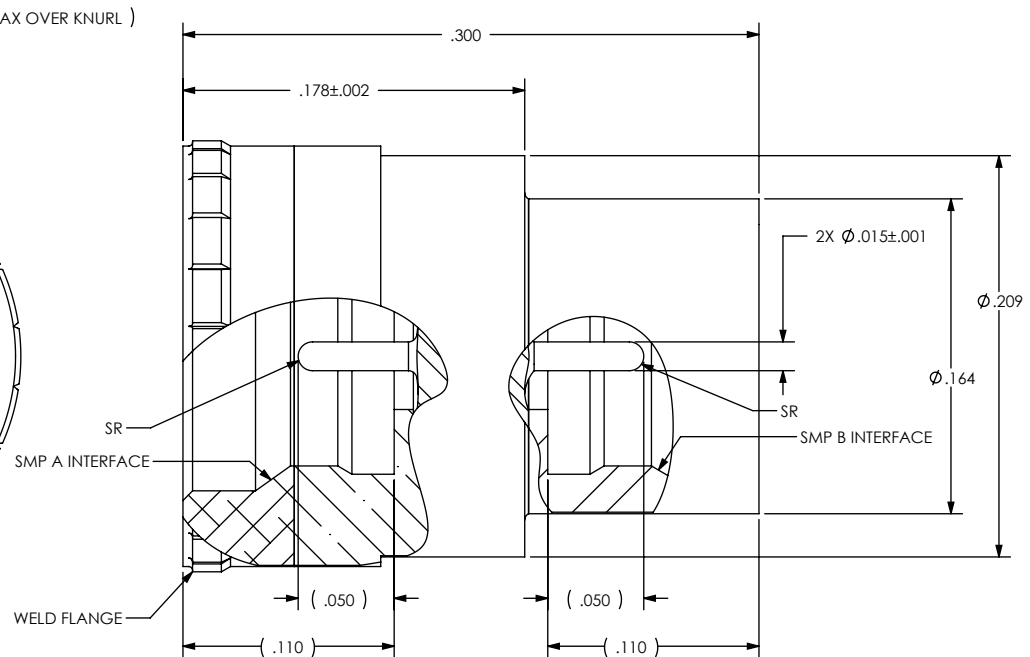
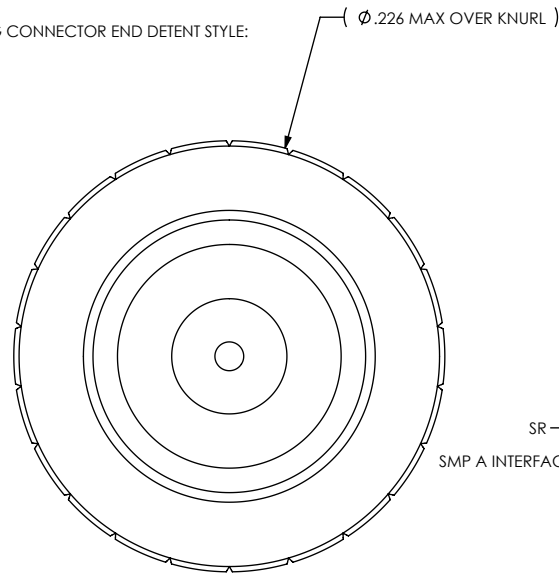

.040 ANNULAR RING  
 REQUIRED FOR LASER WELDING  
 NO PLATING ALLOWED

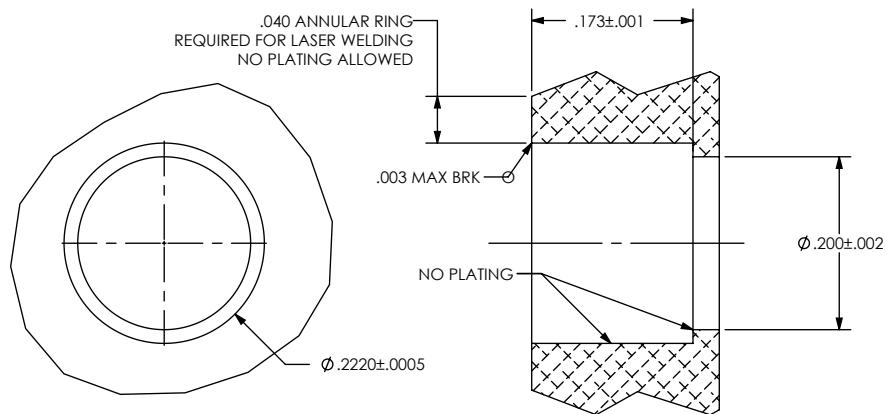

UNLESS OTHERWISE SPECIFIED  
 DIMENSIONING IAW ASME Y14.5M-1994  
 DIMENSIONS APPLY AFTER PROCESSES  
 DIMENSIONS IAW US CUSTOMARY UNITS  
 .X ± .1, .XX ± .01, .XXX ± .005, <math>\angle \pm .5^\circ</math>  
 .010 MAX OUTSIDE R, .005 MAX INSIDE R  
 125 RMS SURFACE FINISH



(321) 254-4067  
 WWW.SRIHERMETICS.COM

TITLE: FEEDTHROUGH, SMP TO SMP, AC LBW

THIRD ANGLE PROJECTION

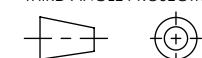

SIZE	DOCUMENT	SRIFT519	REV
A			-
SCALE	CAGE CODE	3PJY7	SHEET
10:1			1 OF 1